

LineaCompact (Type 2) Sliding Door Frame - for Brick Walls

Included in  BOS delivery:

- sliding door frame LineaCompact
- 1 door runner rail (mounted)
- 2 running carriages (unattached)
- 2 bearing flanges (unattached)
- 2 rail stoppers (unattached)
- 1 guiding pin (mounted)
- 8 standard nail anchors (unattached)
- 8 flat nail anchors (unattached)
- construction panels
- joint reinforcement tape
- 1 installation instructions

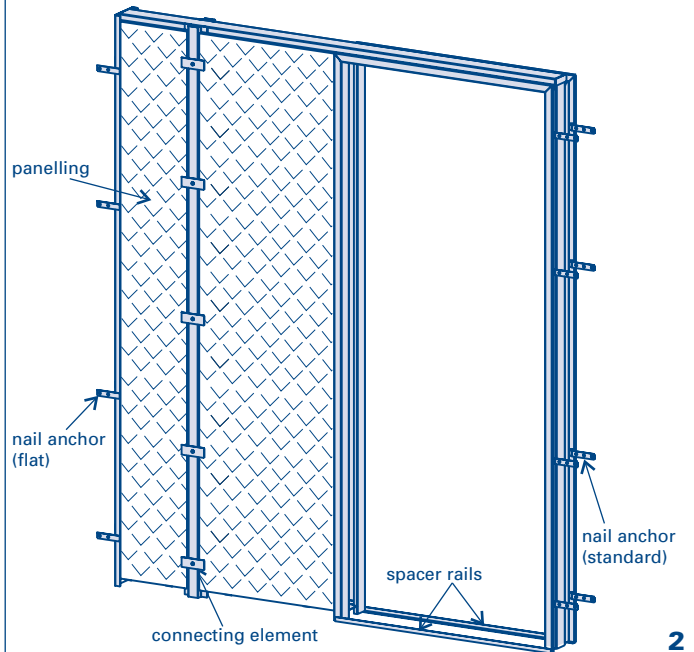
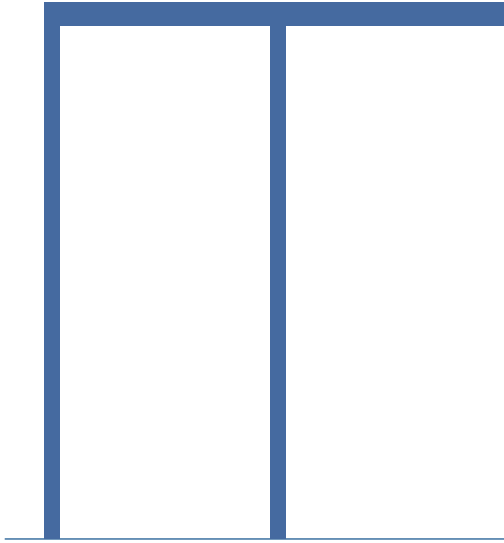

Rev. 02; February 2007

2

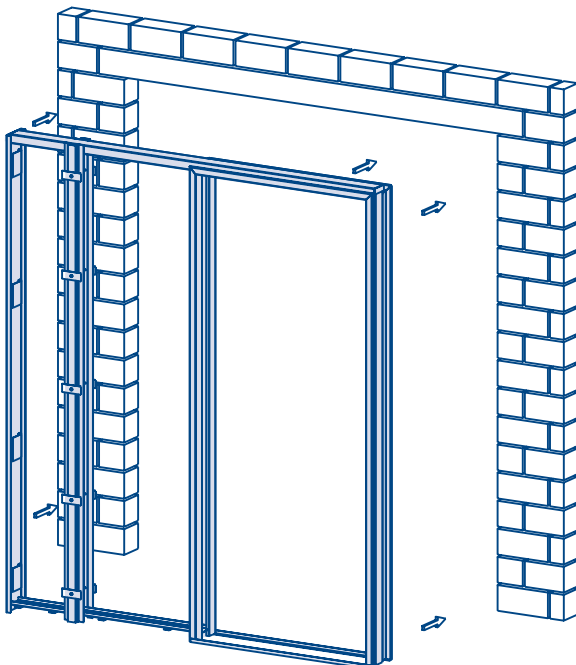

1. Prepare the mortar filling openings behind the frame. Establish the metre mark on the brick wall. (According to VOB DIN 18360 / 3.1.1.1, determining the metre mark is the customers' responsibility.) Push the frame into the wall opening and align the metre mark on the frame with that on the wall by using suitable padding under the frame. Note: The upper edge of finished floor (OFF) is 30mm higher than the lower edge of the frame (only by frames with foundation bedding).

3

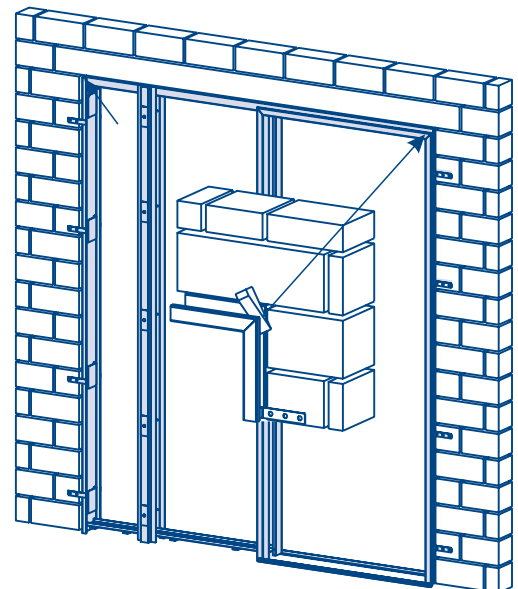

2. Insert wedges at all four corners of the headpiece of the frame. Make sure that there is the same distance overall between the wall and the frame. Check the perpendicular alignment of the frame.

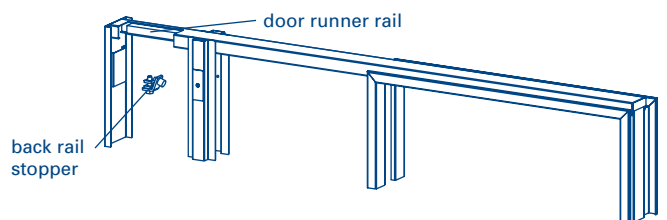

3. Position the back rail stopper in the door runner rail.

4

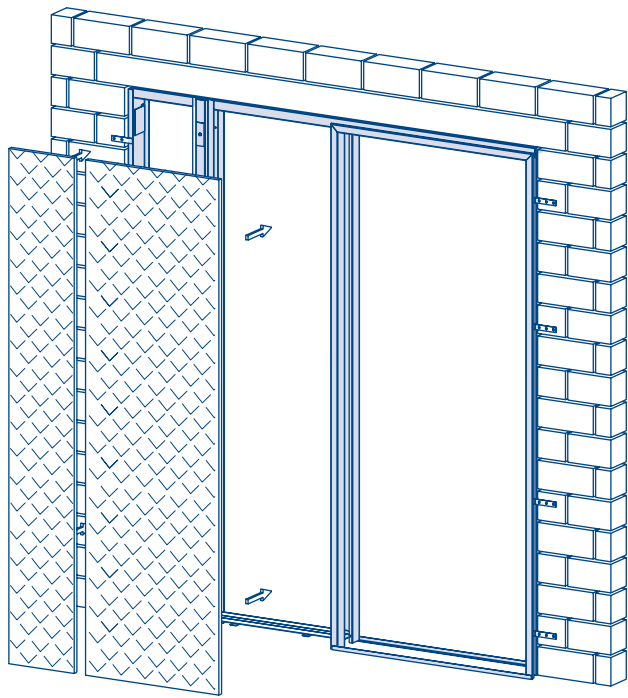

4. Insert the construction panels and fasten.

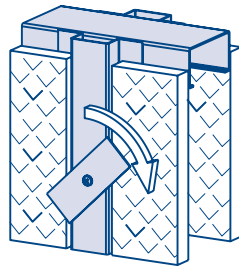

5

5. Insert the flat nail anchors between the panelling and the edge of the frame without forcing, and then attach them to the brick wall.

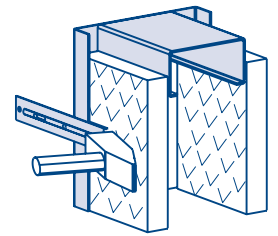

6. Hook the standard nail anchors around the frame and fasten to the brick wall.

7. Measure the rebate width at the frame head. Ensure that this measurement is withheld in the middle of the frame using a spacer board to avoid a narrowing of the through-way during mortar filling.

8. Fill in moist mortar mixture (approx. 1:4) through the prepared openings until the entire gap between the frame and the wall is filled including above the head-piece. By knocking on the frame soffit during filling, it is possible to ensure that the gap is totally filled. Once the gap is filled, remove mortar splatters from the frame.

9. Before plastering, the seams between the sliding door frame and the brickwork, as well as the connecting elements of the panelling must be covered with joint reinforcement tape. The panelling should be free of dust and treated with a primer.

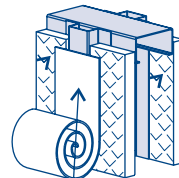

joint reinforcement tape

10. Remove the spacer rails once the mortar has hardened and before the floor pavement is laid.

6

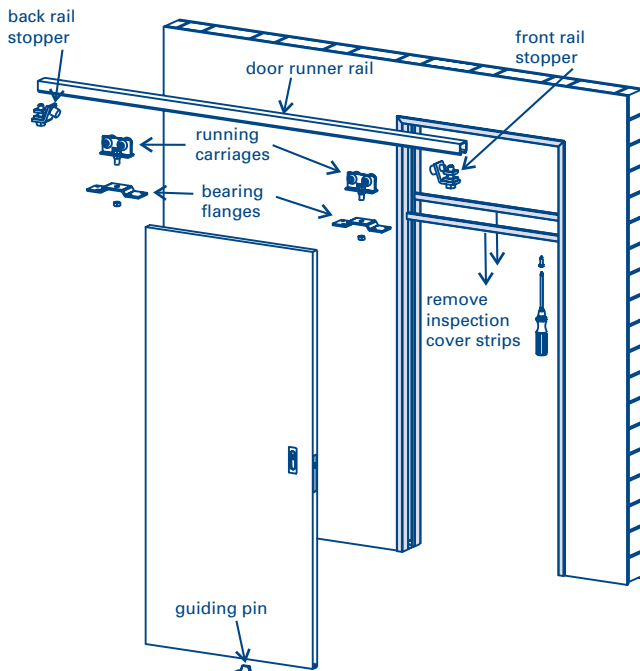

11. To install the sliding door, remove the inspection cover strips, which are situated in the headpiece. The guiding pin and door runner rails are pre-mounted. Hang the back rail stopper and the running carriages onto the door runner rail. Screw the bearing flanges onto the sliding door. Hang the door with the bearing flanges on the adjusting screws of the running carriages and use a SW13 spanner to adjust the screws until the door is at the correct height. The exact distance from the door to the frame border can be regulated over the long hole of the bearing flanges. Finally, tighten the adjusting nuts.

7

Horizontal Section

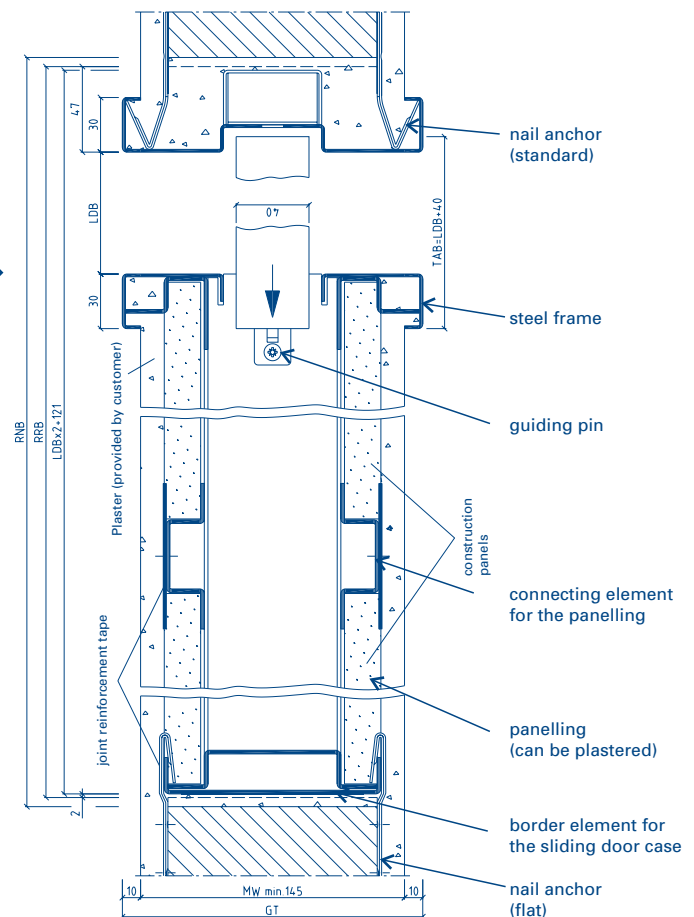

Subject to technical alterations.

8