



BOS

Best Of Steel

Soundproofing

Rev. 01; Dez '05

Airborne sound proofing from BOS-fixed glazing, tested by IFT-Rosenheim according to DIN 52210

Test condition:

- Backing of the frame with open-cell cellular material
- Connection juncture mounting - Wall sealed material on both sides

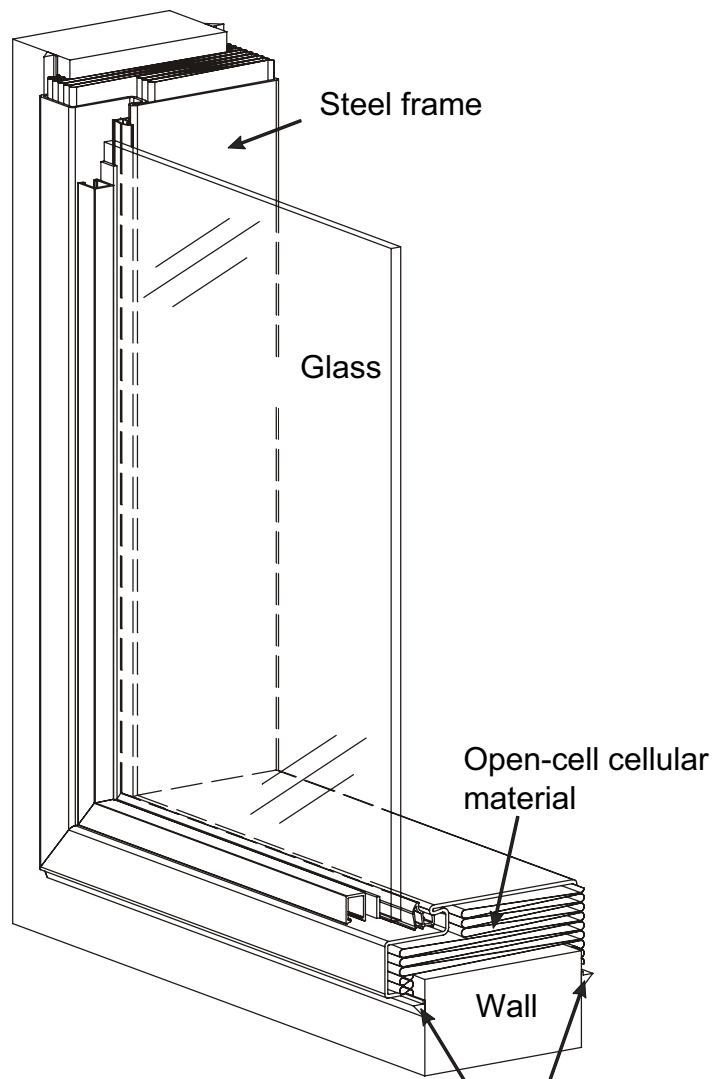

Connection juncture
sealed from both sides



Airborne sound proofing from BOS-fixed glazing,
tested by IFT-Rosenheim according to DIN 52210

a)

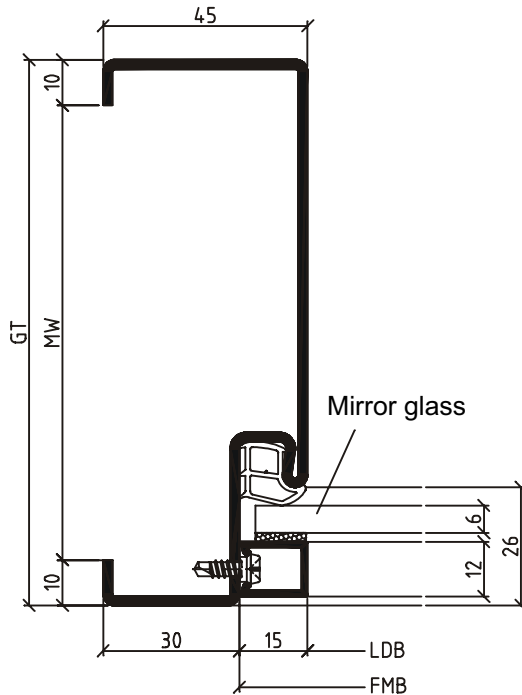

Sound proofing
measurement:

$$R_{w,P} = 31 \text{ dB}$$

$$R_{w,R} = 29 \text{ dB}$$

Pr.Nr.: 16224697/2.0.0

b)

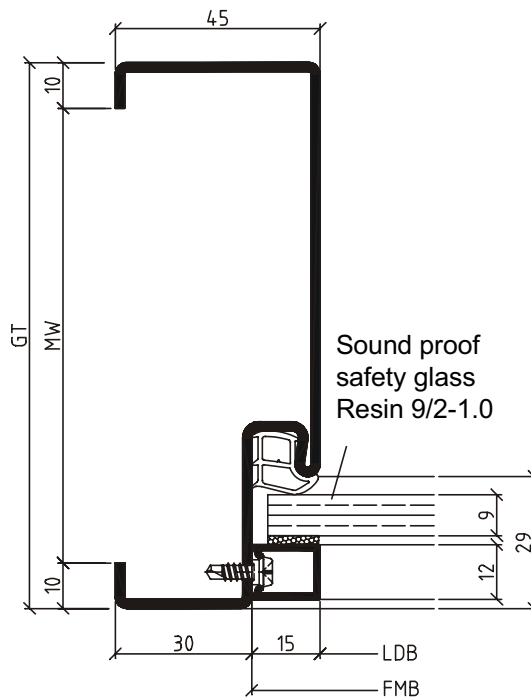

Sound proofing
measurement:

$$R_{w,P} = 37 \text{ dB}$$

$$R_{w,R} = 35 \text{ dB}$$

Pr.Nr.: 16224697/2.4.0



Airborne sound proofing from BOS-fixed glazing,
tested by IFT-Rosenheim according to DIN 52210

c)

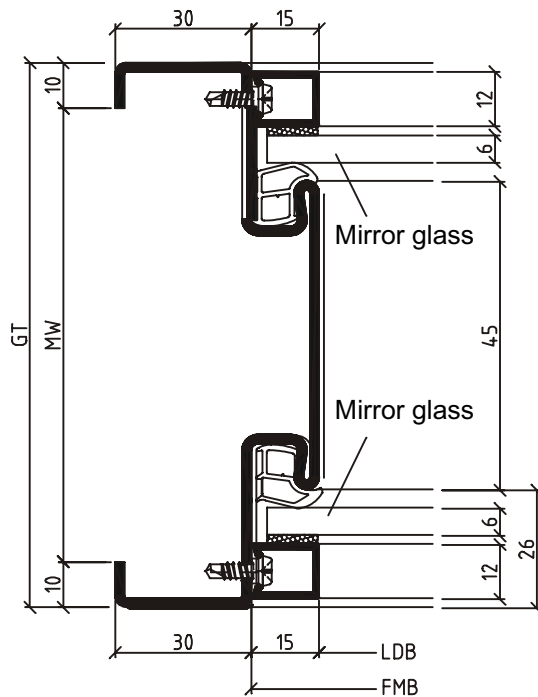

Sound proofing
measurement:

$$R_{w,P} = 39 \text{ dB}$$

$$R_{w,R} = 37 \text{ dB}$$

Pr.Nr.: 16224697/2.1.0

d)

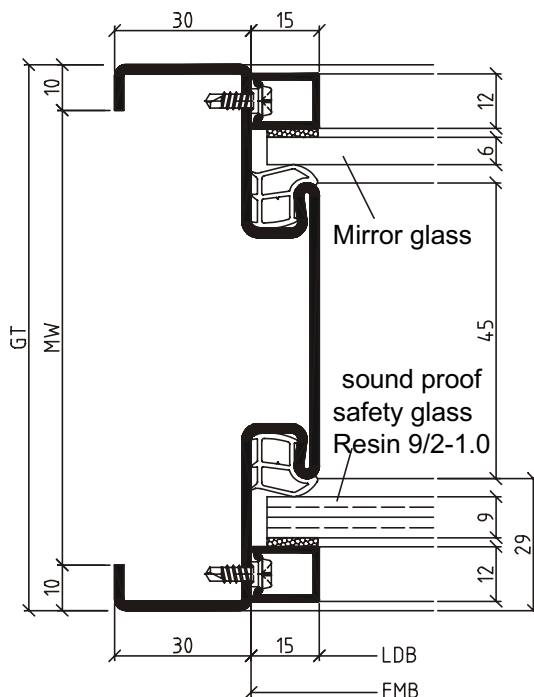

Sound proofing
measurement:

$$R_{w,P} = 47 \text{ dB}$$

$$R_{w,R} = 45 \text{ dB}$$

Pr.Nr.: 16224697/2.2.0



BOS
Best Of Steel

Soundproofing Window

Rev. 01; Dez '05

Airborne sound proofing from BOS-fixed glazing, tested by IFT-Rosenheim according to DIN 52210

e)

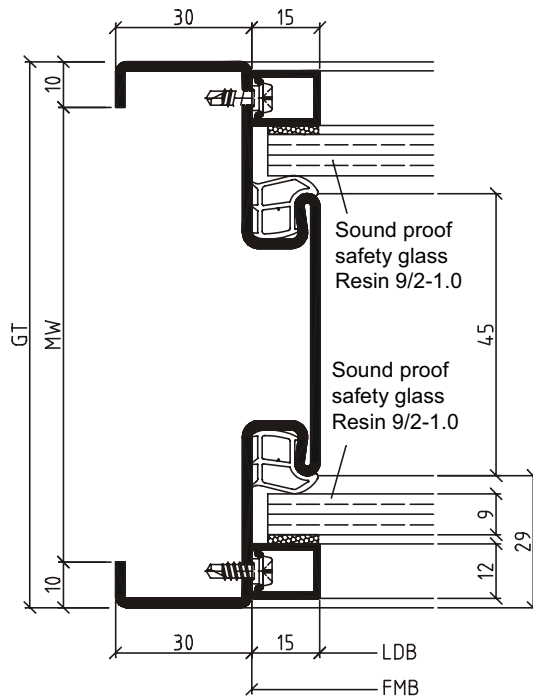

Sound proofing measurement:

$$R_{w,P} = 51 \text{ dB}$$

$$R_{w,R} = 49 \text{ dB}$$

Pr.Nr.: 16224697/2.3.0